

TO-252-2L Plastic-Encapsulate MOSFET

40V N-Channel MOSFET

Product Summary

$V_{(BR)DSS}$	$R_{DS(on)TYP}$	I_D
40V	6.5m Ω @10V	55A
	8.2m Ω @4.5V	

Feature

- Trench Technology Power MOSFET
- Low $R_{DS(ON)}$
- Low Gate Charge
- Low Gate Resistance
- 100% UIS Tested

Application

- Power Switching Application

MARKING:

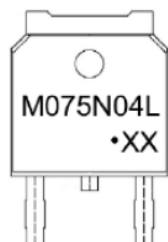

M075N04L = Device Code
 XX = Date Code
 Solid Dot = Green Indicator

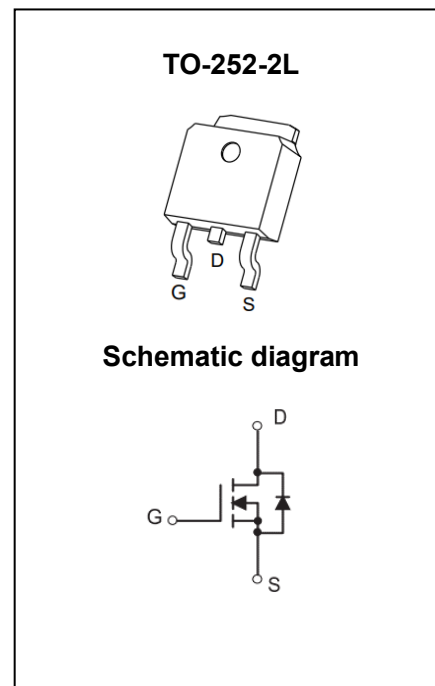

ABSOLUTE MAXIMUM RATINGS ($T_A = 25^\circ\text{C}$ unless otherwise noted)

Parameter	Symbol	Value	Unit	
Drain - Source Voltage	V_{DS}	40	V	
Gate - Source Voltage	V_{GS}	± 20	V	
Continuous Drain Current ¹	$T_C = 25^\circ\text{C}$	I_D	55	A
	$T_C = 100^\circ\text{C}$	I_D	41	A
Pulsed Drain Current ²	I_{DM}	220	A	
Single Pulsed Avalanche Current ³	I_{AS}	27	A	
Single Pulsed Avalanche Energy ³	E_{AS}	182	mJ	
Power Dissipation ⁵	$T_C = 25^\circ\text{C}$	P_D	41.5	W
Thermal Resistance from Junction to Ambient ⁶	$R_{\theta JA}$	55	$^\circ\text{C/W}$	
Thermal Resistance from Junction to Case	$R_{\theta JC}$	3	$^\circ\text{C/W}$	
Junction Temperature	T_J	150	$^\circ\text{C}$	
Storage Temperature	T_{STG}	-55~ +150	$^\circ\text{C}$	

Electrical Characteristics ($T_A=25^\circ\text{C}$ unless otherwise noted)

Parameter	Symbol	Test Condition	Min	Type	Max	Unit
Off Characteristics						
Drain - Source Breakdown Voltage	$V_{(BR)DSS}$	$V_{GS} = 0V, I_D = 250\mu A$	40			V
Zero Gate Voltage Drain Current	I_{DSS}	$V_{DS} = 32V, V_{GS} = 0V$			1	μA
Gate - Body Leakage Current	I_{GSS}	$V_{GS} = \pm 20V, V_{DS} = 0V$			± 100	nA
On Characteristics⁴						
Gate Threshold Voltage	$V_{GS(th)}$	$V_{DS} = V_{GS}, I_D = 250\mu A$	1	1.7	3	V
Drain-source On-resistance	$R_{DS(on)}$	$V_{GS} = 10V, I_D = 20A$		6.5	8.5	m Ω
		$V_{GS} = 4.5V, I_D = 10A$		8.2	12	
Forward Transconductance	g_{FS}	$V_{DS} = 10V, I_D = 10A$				S
Dynamic Characteristics						
Input Capacitance	C_{iss}	$V_{DS} = 20V, V_{GS} = 0V, f = 1MHz$		2896		pF
Output Capacitance	C_{oss}			190		
Reverse Transfer Capacitance	C_{rss}			157		
Gate Resistance	R_g	$V_{DS} = 0V, V_{GS} = 0V, f = 1MHz$		2		Ω
Switching Characteristics						
Total Gate Charge	Q_g	$V_{DS} = 30V, V_{GS} = 10V, I_D = 20A$		51		nC
Gate-source Charge	Q_{gs}			9		
Gate-drain Charge	Q_{gd}			7.7		
Turn-on Delay Time	$t_{d(on)}$	$V_{DD} = 30V, V_{GS} = 10V, R_L = 1.5\Omega$ $R_G = 3\Omega$		9		ns
Turn-on Rise Time	t_r			22		
Turn-off Delay Time	$t_{d(off)}$			45		
Turn-off Fall Time	t_f			22		
Source - Drain Diode Characteristics						
Diode Forward Voltage ⁴	V_{SD}	$V_{GS} = 0V, I_S = 10A$			1.2	V

Notes :

- 1.The maximum current rating is limited by package.And device mounted on a large heatsink
- 2.Pulse Test : Pulse Width $\leq 10\mu s$, duty cycle $\leq 1\%$.
- 3.EAS condition: $V_{DD} = 20V, V_{GS} = 10V, L = 0.5mH, R_G = 25\Omega$ Starting $T_J = 25^\circ\text{C}$.
- 4.Pulse Test : Pulse Width $\leq 300\mu s$, duty cycle $\leq 2\%$.
- 5.The power dissipation P_D is limited by $T_{J(MAX)} = 150^\circ\text{C}$.And device mounted on a large heatsink
- 6.Device mounted on $1in^2$ FR-4 board with 2oz. Copper, in a still air environment with $T_A = 25^\circ\text{C}$.

Typical Characteristics

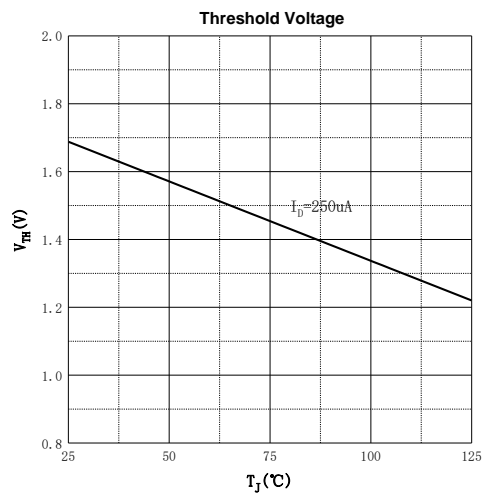
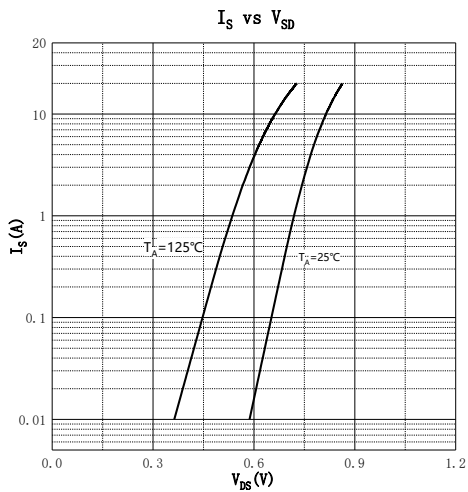
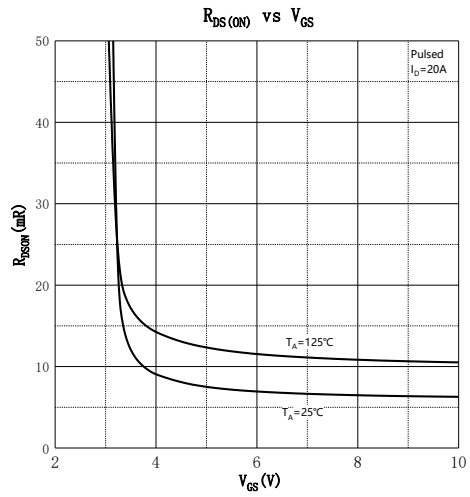
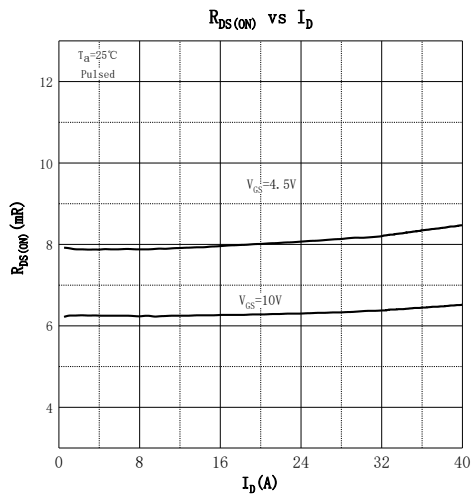
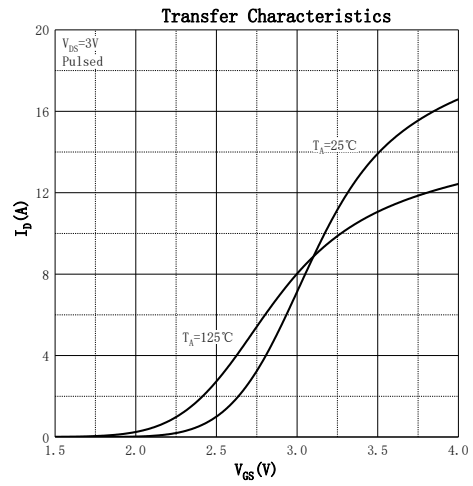
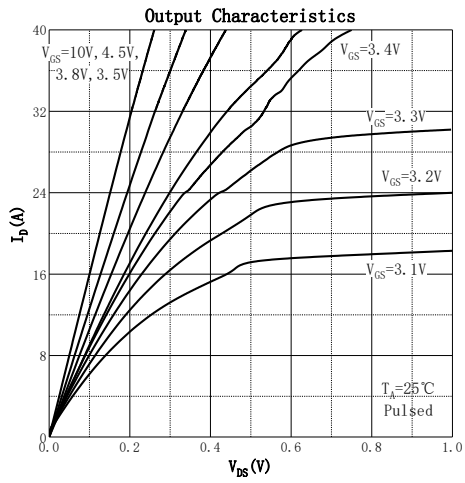

Typical Characteristics

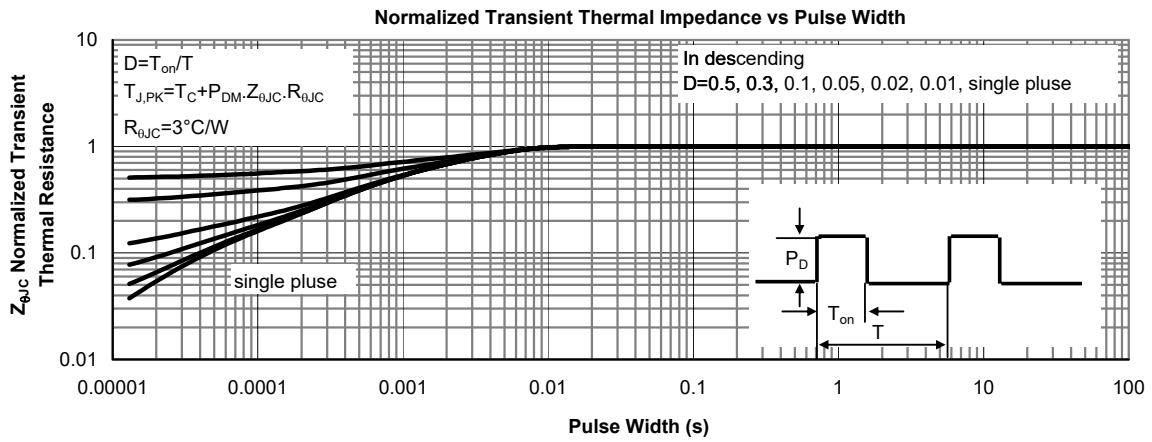
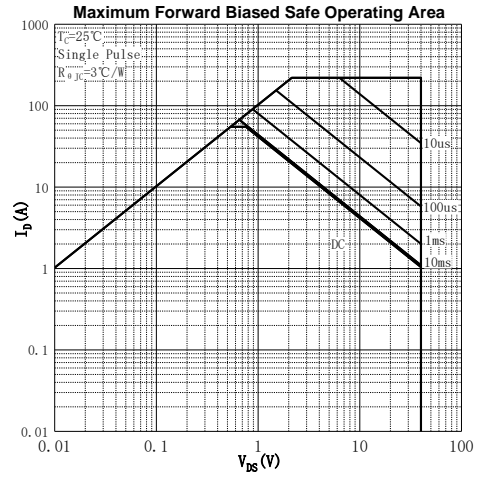
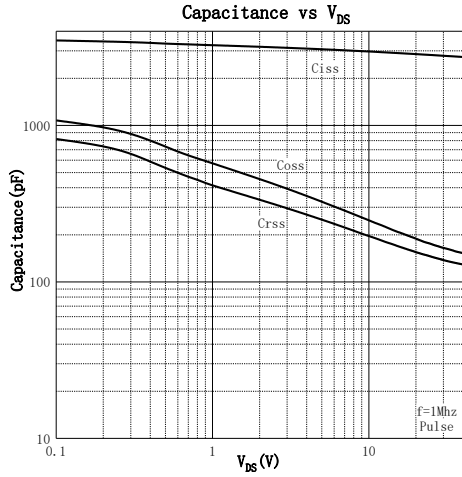

TO-252-2L Package Outline Dimensions

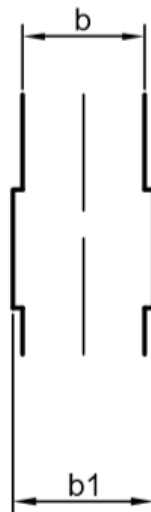
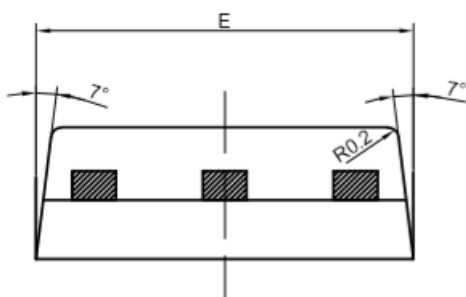
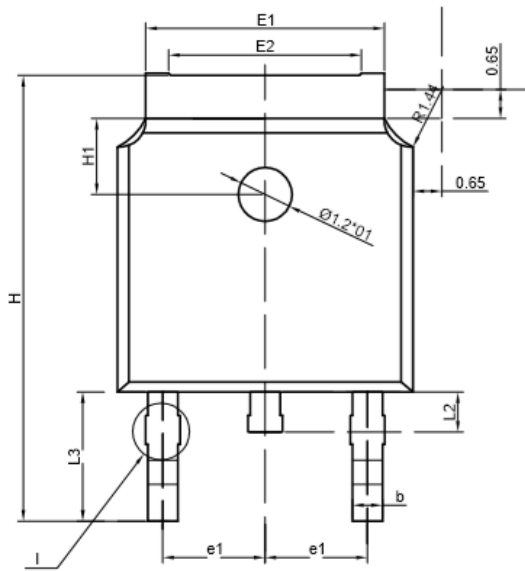

DETAIL I

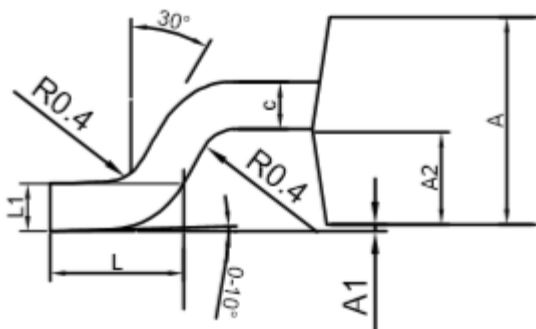

SYMBOL	MIN	NOM	MAX
A	2.29	2.30	2.31
A1	0.00	0.07	0.15
A2	1.020	1.025	1.030
b	0.645	0.670	0.695
b1	0.67	0.77	0.87
c	0.523	0.528	0.533
c1	0.498	0.508	0.518
D	6.09	6.10	6.11
D1	5.244	5.249	5.254
E	6.50	6.60	6.70
E1	5.284	5.334	5.384
E2	4.284	4.334	4.312
e	4.821	4.826	4.831
e1	2.281	2.286	2.291
e2	4.059	4.064	4.069
H	9.8	10.0	10.2
H1	1.5	1.6	1.7
h	1.316	1.321	1.326
h1	0.757	0.762	0.767
L	1.4	1.5	1.6
L1	0.50	0.51	0.52
L2	0.8	0.9	1.0
L3	2.88	2.888	2.893

NOTICE

JSHD reserve the right to make modifications, enhancements, improvements, corrections or other changes without further notice to any product herein. JSHD does not assume any liability arising out of the application or use of any product described herein.