

## TO-277 Plastic-Encapsulate Diodes

### Schottky Rectifier

#### Features

- $I_o$  10A
- $V_{RRM}$  300V
- High surge current capability

#### Applications

- Rectifier

#### Marking

- SP10V300L

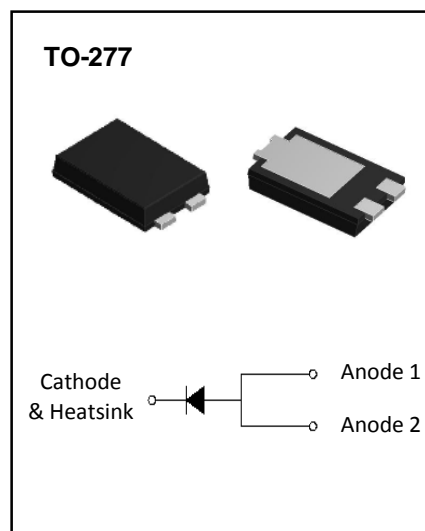

#### MAXIMUM RATINGS

$T_A=25^\circ\text{C}$  unless otherwise noted

Parameter	Symbol	Value	Unit
Repetitive Peak Reverse Voltage	$V_{RRM}$	300	V
Average Forward Rectified Current	$I_{F(AV)}$	10	A
Peak Forward Surge Current (8.3 ms single half sine-wave superimposed on rated load)	$I_{FSM}$	120	A
Operating Junction Temperature Range	$T_J$	-55 to +150	$^\circ\text{C}$
Storage Temperature Range	$T_{STG}$	-55 to +150	$^\circ\text{C}$

#### ELECTRICAL CHARACTERISTICS

$T_A=25^\circ\text{C}$  unless otherwise noted

Parameter	Test Conditions	Symbol	Value		Unit
			Typ.	Max.	
Forward Voltage@ $I_F=3\text{A}$	$T_A=25^\circ\text{C}$	$V_F$	0.79	0.82	V
	$T_A=125^\circ\text{C}$		0.7	0.75	
Forward Voltage@ $I_F=10\text{A}$	$T_A=25^\circ\text{C}$		0.93	0.97	
	$T_A=125^\circ\text{C}$		0.83	0.88	
Reverse Current @ $V_{RRM}$	$T_A=25^\circ\text{C}$	$I_R$	1	10	$\mu\text{A}$
	$T_A=125^\circ\text{C}$		0.6	5	mA
Typical Thermal Resistance		$R_{\theta JA}$	88		$^\circ\text{C}/\text{W}$

# Typical Characteristics

**FIG.1: Forward Output Current Derating Curve**

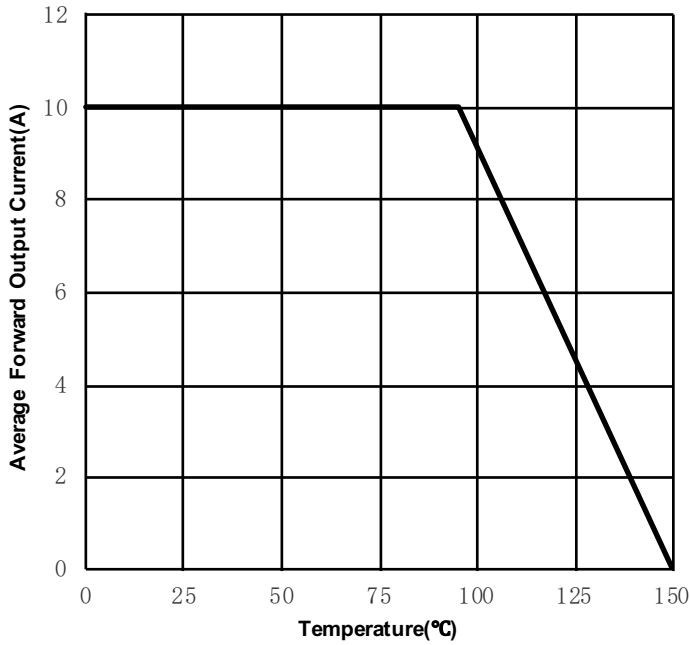

**FIG.2: Maximum Non-Repetitive Peak Forward Surge Current**

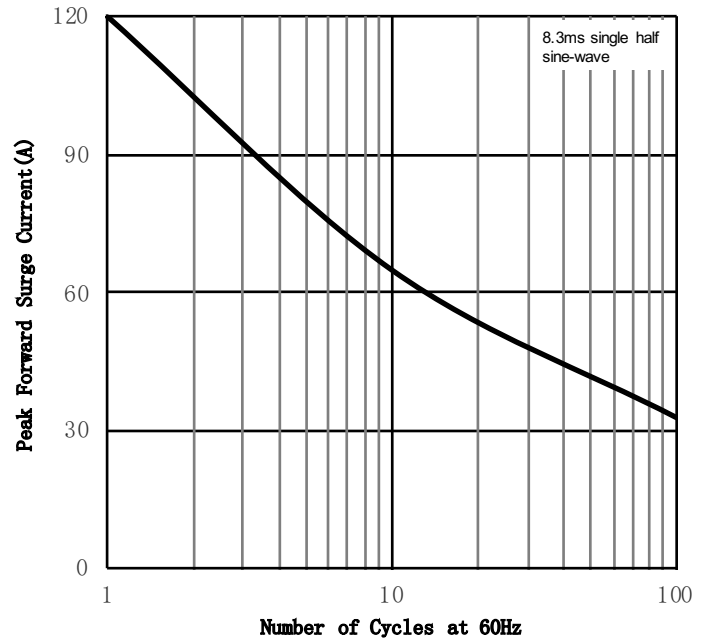

**FIG.3: Typical Forward Characteristics**

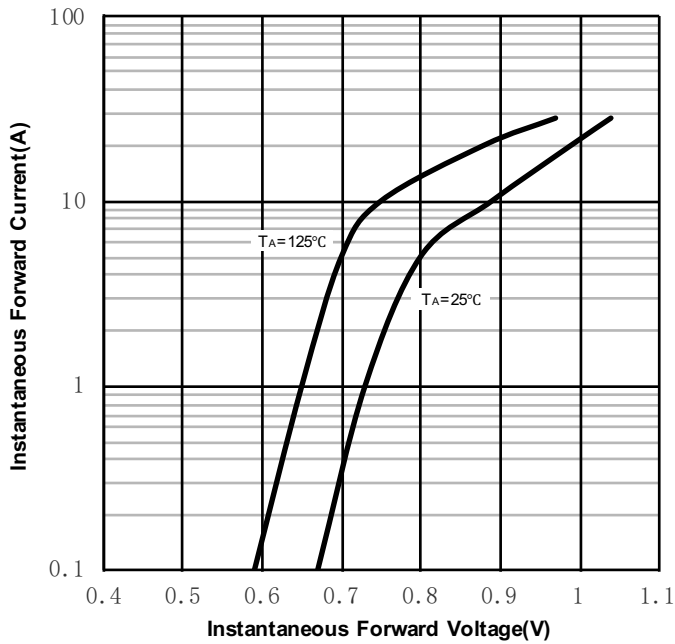

**FIG.4: Typical Reverse Characteristics**

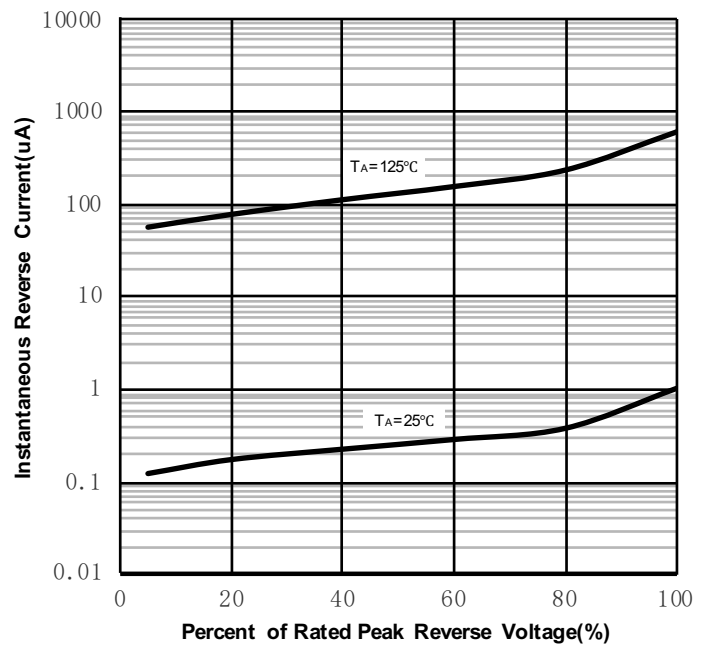

## TO- 277 Package Outline Dimensions

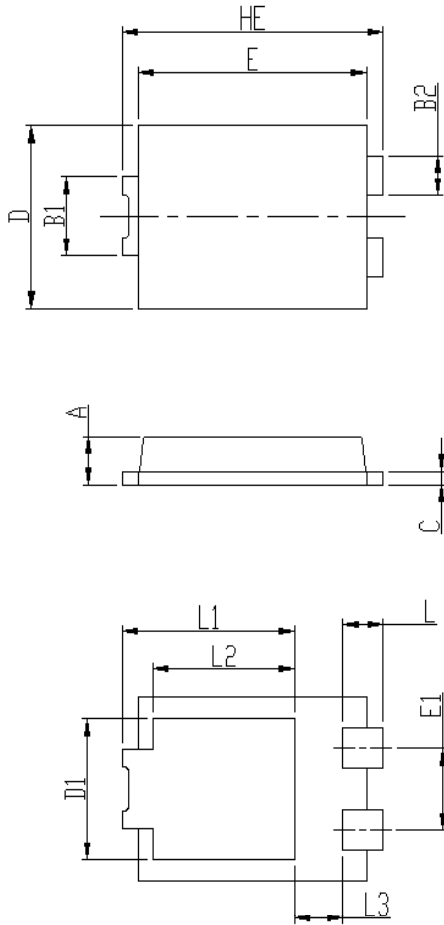

DIM	Unit: mm		Unit: inch	
	MIN	MAX	MIN	MAX
HE	6.4	6.6	0.252	0.260
E	5.6	5.8	0.220	0.228
D	4.1	4.3	0.161	0.169
B1	1.7	1.9	0.067	0.075
B2	0.8	1	0.031	0.039
A	1.05	1.2	0.041	0.047
C	0.3	0.4	0.012	0.016
L	0.85	1.1	0.033	0.043
L1	4.2	4.4	0.165	0.173
L2	3.52 Typ.		0.139 Typ.	
L3	1.1	1.4	0.043	0.055
D1	3	3.3	0.118	0.130
E1	1.86 Typ.		0.073 Typ.	

## TO- 277 Suggested Pad Layout

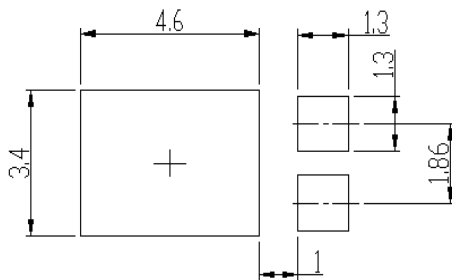

### Note:

1. Controlling dimension: in millimeters.
2. General tolerance:  $\pm 0.05$ mm.
3. The pad layout is for reference purposes only.

### NOTICE

JSHD reserve the right to make modifications, enhancements, improvements, corrections or other changes without further notice to any product herein. JSHD does not assume any liability arising out of the application or use of any product described herein.