

40V-1A Schottky Barrier Diode

**HALOGEN
FREE**

Feature

- Low Forward Voltage Drop
- Very Small SMD Package

Application

- Low Voltage Rectification
- High Efficiency DC/DC Conversion
- Switch Mode Power Supply
- Inverse Polarity Protection
- Low Power Consumption Applications

MARKING:

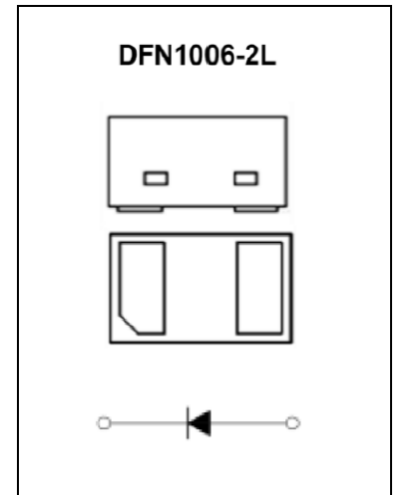

ABSOLUTE MAXIMUM RATINGS (T_A=25°C unless otherwise noted)

Parameter	Symbol	Value	Unit
DC reverse voltage	V _R	40	V
Mean rectifying current	I _O	1	A
Non-repetitive Peak Forward Surge Current @ t=8.3ms	I _{FSM}	7	A
Power Dissipation	P _D	0.25	W
Thermal Resistance from Junction to Ambient	R _{θJA}	400	°C/W
Junction Temperature	T _J	125	°C
Storage Temperature	T _{STG}	-55 ~ +150	°C

ELECTRICAL CHARACTERISTICS (T_A=25°C unless otherwise noted)

Parameter	Symbol	Test Condition	Min	Type	Max	Unit
Reverse voltage	V _{BR}	I _R = 1mA	40			V
Reverse current	I _R	V _R = 40V		10	40	μA
Forward voltage	V _F	I _F = 0.1A		0.35	0.38	V
		I _F = 0.2A		0.37	0.42	V
		I _F = 0.5A		0.42	0.49	V
		I _F = 0.7A		0.47	0.55	V
		I _F = 1A		0.51	0.61	V
Total capacitance	C _{tot}	V _R =10V, f=1MHz		19		pF

Typical Characteristics

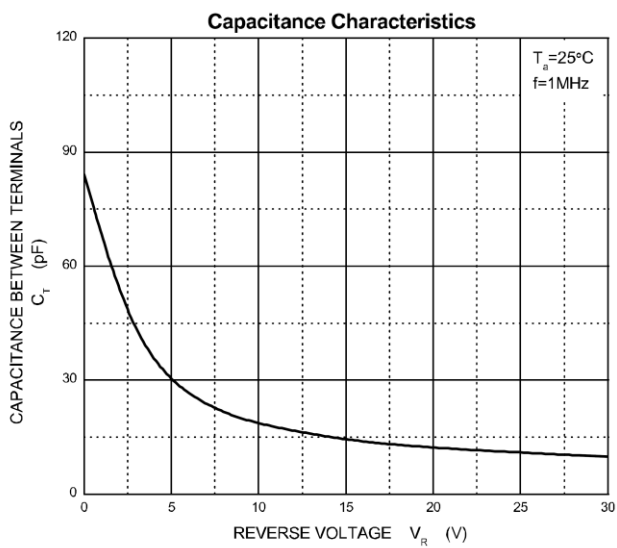
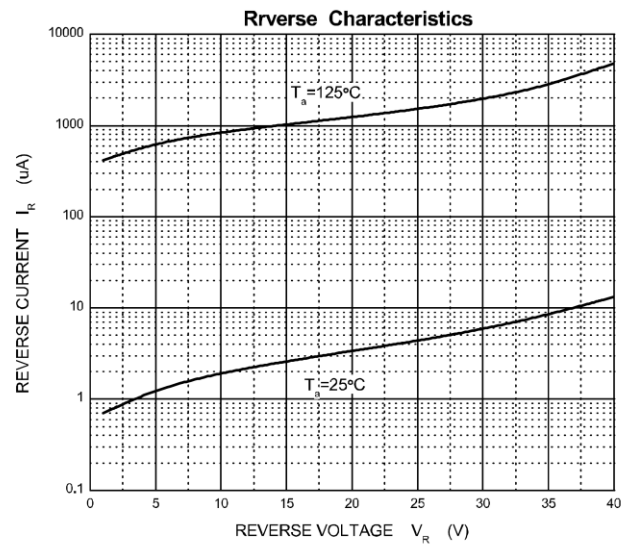
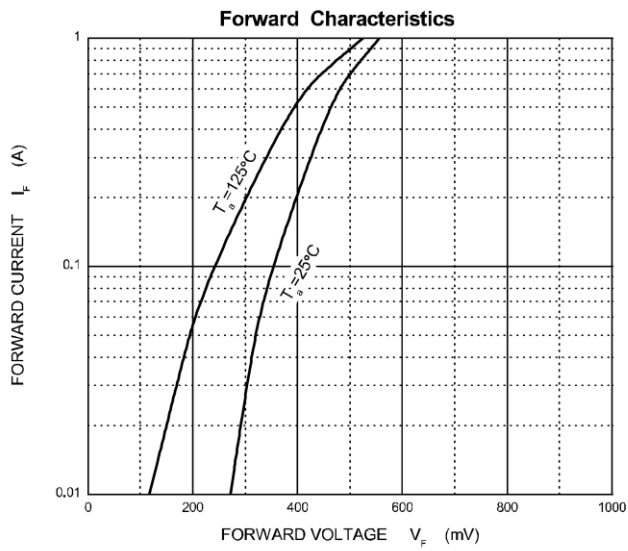

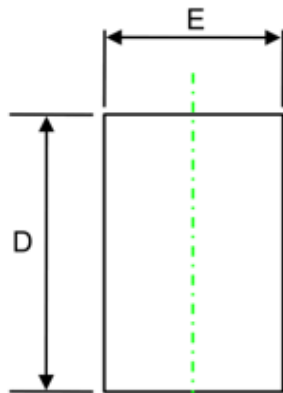

TOP VIEW
[顶视图]

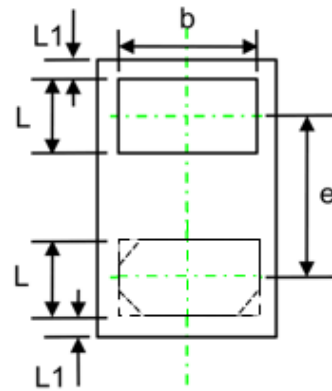

BOTTOM VIEW
[底视图]

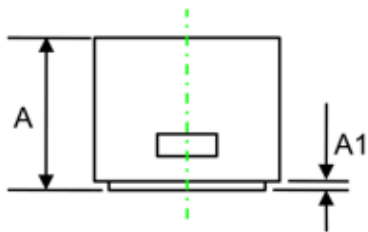

SIDE VIEW
[侧视图]

Symbol	Dimensions In Millimeters		Dimensions In Inches	
	Min.	Max.	Min.	Max.
A	0.400	0.550	0.016	0.022
A1	0.000	0.050	0.000	0.002
D	0.950	1.050	0.037	0.041
E	0.550	0.650	0.022	0.026
b	0.400	0.600	0.016	0.024
e	0.65 TYP		0.026 TYP	
L1	0.05 REF		0.002 REF	
L	0.200	0.300	0.008	0.012